



VisionLINE Safety Vent AIR
Walkthrough

For more information
on this ground-breaking new
product, scan the QR code above.



visionLINE™

SAFETY VENT AIR

VISIONLINE SAFETY VENT AIR OVERVIEW

Constructed fully with high grade 304/316 stainless steel, the VisionLINE Safety Vent AIR is built with a durable black powder coat finish which is ideal for coastal areas.

When in operation, exhaust and air intake is created via the patent coaxial design stove pipe and insulated Safety Vent pipe.

Due to the unique design of the flue, wind noise is reduced by up to 95% compared to older kits, and the possibility of cold drafts coming into the house are also eliminated. Overall unit performance is increased with the insulated balance flue design making your fire easier to start and increasing burn time.

The simplistic twist lock design makes installation simple and easy. Due to CE and EN certification, there is no need for banding or screws at the joins as the pipe has been tensile tested, compression tested and wind tunnel tested. This testing

also allows for allow for up to 3 metres of unsupported pipe run from the ceiling brace. Safety Vent AIR is the only pipe on the Australian market to hold this certification.

Installing the Safety Vent AIR through an insulated ceiling also removes the need for a ventilated drop box which saves up to 876lt/m of air loss. This coupled with the sleek flush fitting ceiling ring makes the pipe a true room sealed system.

Tested to Australian Standards Appendix F and B AS/NZS 2918, the Safety Vent AIR can be fitted to all fireplaces in Australia and New Zealand with 200mm (8") and 150mm (6") spigots.

Visionline Safety Vent AIR requires no extra shielding to be fitted and is the only insulated flue system on the market with 25mm clearance to combustibles.

The pipe is also certified for installation into to BAL-FZ and BAL-40 areas per AS 1530.8.2 (as required by AS3959).

Safety Vent AIR

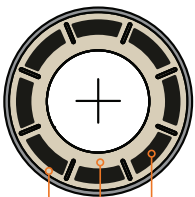



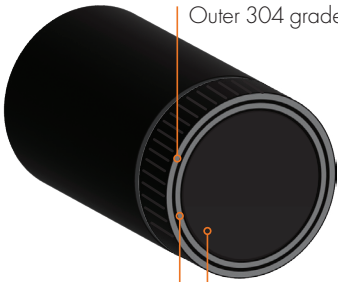

25mm air gap
25mm insulation
12mm insulation

Stove Pipe



Outer 304 grade
Inner 316 grade
Inner carbon composite





WARRANTY

Your VisionLINE Safety Vent AIR system is covered by a ten (10) year manufacturers warranty on defects to the flue system due to manufacture. This does not cover damage due to incorrect installation or abuse of the product beyond specification.



Air intake



BAL-FZ approved



Room sealed



95% Wind Noise Reduction



25mm clearance



Insulated twist lock

Default Flue

High quality, designed in Australia and simple to install, the VisionLINE default flue melds seamlessly into any home.

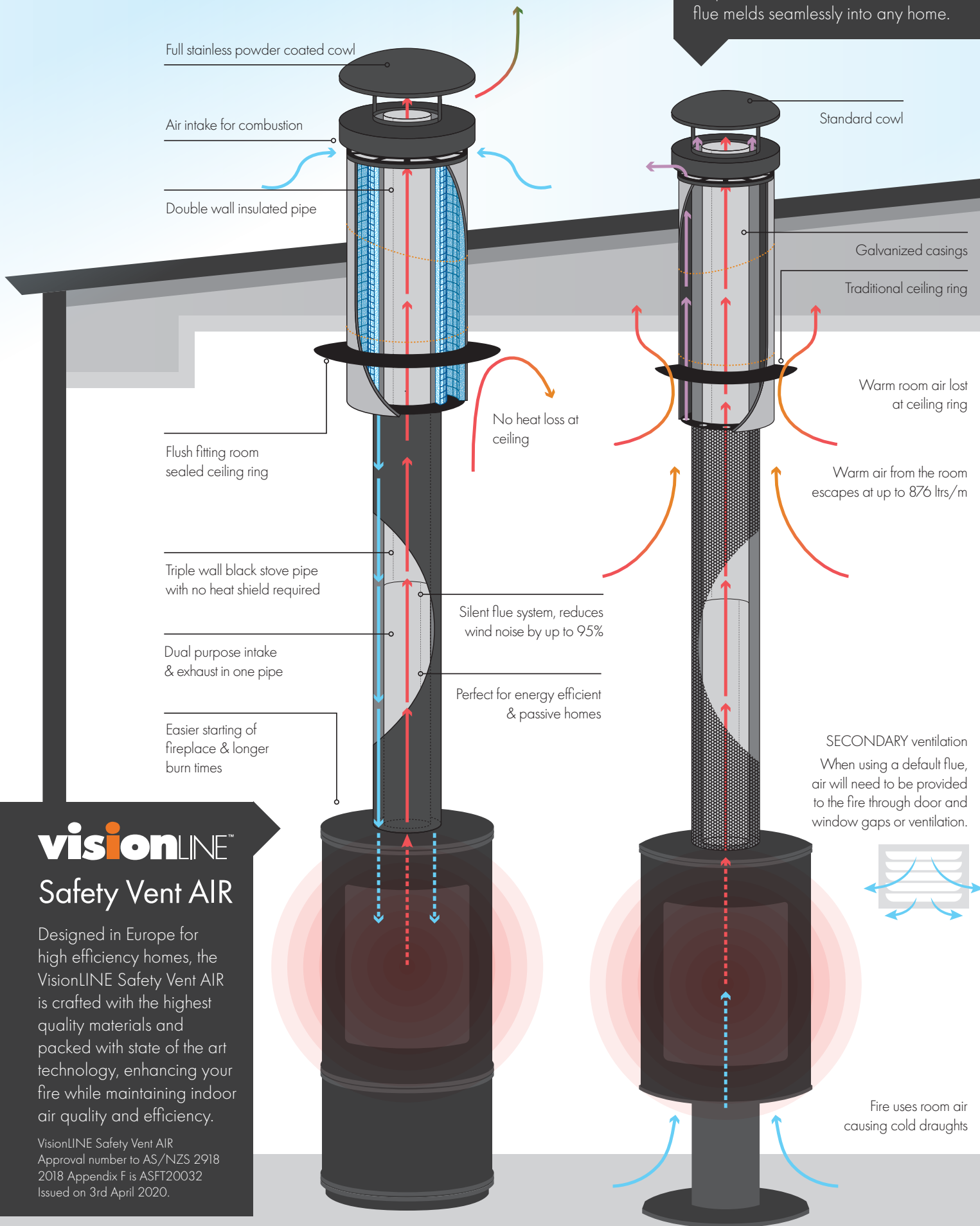

visionLINE™ Safety Vent AIR

Designed in Europe for high efficiency homes, the VisionLINE Safety Vent AIR is crafted with the highest quality materials and packed with state of the art technology, enhancing your fire while maintaining indoor air quality and efficiency.

VisionLINE Safety Vent AIR
Approval number to AS/NZS 2918
2018 Appendix F is ASFT20032
Issued on 3rd April 2020.

COMPONENT SPECS

Product

150mm

200mm

Stove pipe elbow

VF-3-60-145
VF-3-80-145

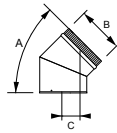

A	45°
B	193 mm
C	65 mm
C X 2	148 mm

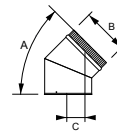

A	45°
B	243mm
C	99mm
C X 2	180mm

Flush spigot adapter

VF-3-60-092
VF-3-80-092



To be used when the fire place has a hidden spigot.

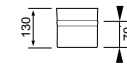

To be used when the fire place has a hidden spigot.

T-Section

VF-3-60-090
VF-3-80-090

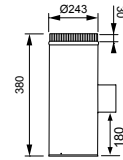
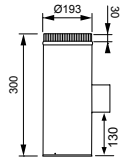

Stove pipe

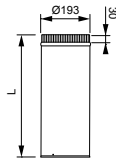

Part number	Joined length	Total length
VF-3-60-100	220mm	250mm
VF-3-60-102	470mm	500mm
VF-3-60-106	970mm	1000mm
VF-3-60-107	1170mm	1200mm

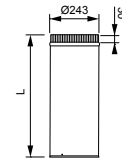

Part number	Joined length	Total length
VF-3-80-100	220mm	250mm
VF-3-80-102	470mm	500mm
VF-3-80-106	970mm	1000mm
VF-3-80-107	1170mm	1200mm

Adjustable stove pipe

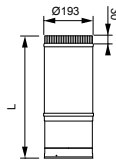

Part number	L min.	L Max.
VF-3-60-104	420mm	610mm
VF-3-60-105	620mm	1080mm

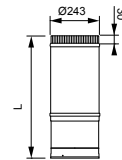

Part number	L min.	L Max.
VF-3-80-104	300mm	600mm
VF-3-80-105	500mm	1000mm

Stove pipe to safety vent adapter

VF-3-60-108
VF-3-80-108

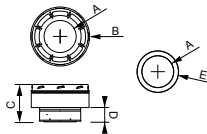

A	Ø150 mm
B	Ø275 mm
C	175 mm
D	65 mm
E	Ø193 mm

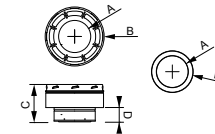

A	Ø200mm
B	Ø352mm
C	193mm
D	65mm
E	Ø243mm

Ceiling ring

VF-3-60-110
VF-3-80-110

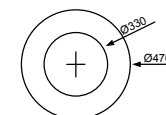
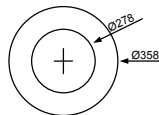

Safety vent pipe

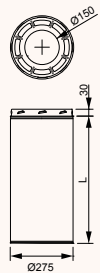

Part number	Joined length	Total Length
VF-3-60-200	200mm	230mm
VF-3-60-201	250mm	280mm
VF-3-60-202	475mm	505mm
VF-3-60-203	975mm	1005mm

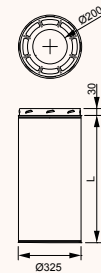

Part number	Joined length	Total Length
VF-3-80-200	200mm	230mm
VF-3-80-201	250mm	280mm
VF-3-80-202	475mm	505mm
VF-3-80-203	975mm	1005mm
VF-3-80-204	1198mm	1228mm

Safety vent cowl

VF-3-60-001
VF-8-80-001

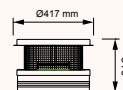
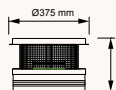

Stove pipe elbow

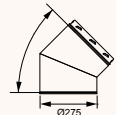

Part number	Angle
VF-3-60-245	45°

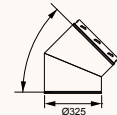

Part number	Angle
VF-8-80-010	15°
VF-8-80-206	30°

Below the ceiling

Above the ceiling